

Thermal Printer Mechanism

LTP02



LTP02-245

- Max. printing speed: 90mm/sec
- Extremely compact design for mobile terminal
- Light weight only 28g

Model		LTP02-245
Printing	Method	Thermal line dot printing
	Number of dots/line	384
	Resolution (dots/mm)	8
	Paper width (mm)	58 ⁺⁰ ₋₁
	Printing width (mm)	48
	Speed (mm/sec)max	90
	Paper path	Curved
Detection	Head temperature	By thermistor
	Out of paper	By photo interrupter
Power supply (V)	Operation voltage (Vdd)	3.0 to 3.6
	Operation voltage (Vp)	5.5 to 8.0
Peak current (A)	Head	2.23(8.0V / 45 dots)
	Motor	0.6
Service life	Pulse activation (pulse)	100 million
	Abrasion resistance (km)	50 *1
Operating temperature (°C)		-10 to 50
Dimensions (W x D x H mm)		67.3 x 18.1 x 30.0 *2
Mass (g)		Approx.28

*1 Use recommended thermal papers *2 Excluding protrusion

Smart design for terminal minimization !

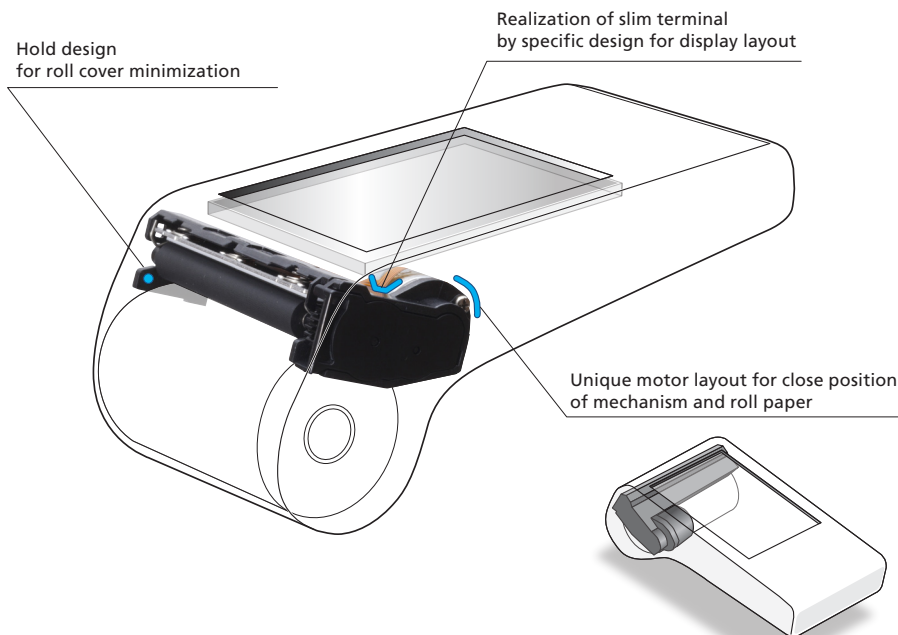

Specifications are subject to change without notice.



Seiko Instruments GmbH
 Siemensstraße 9
 D-63263 Neu-Isenburg, Germany
 Phone +49 6102 297 100
 Fax +49 6102 297 50 100
 info@seiko-instruments.de
 www.seiko-instruments.de

