

SHIELDPACK™ HV RCS800 SI DM



ShieldPack™
HV RCS800 SI DM 2W



AVAILABLE CONFIGURATIONS

| | |
|--------------------------------|--------------------------------------|
| Connector Type | Wire-to-device |
| Cable Exit Orientation | 180° |
| Cable Range (mm ²) | 35 - 50 (power) 0.35 - 1.0 (HVIL) |
| Terminal Type | 8 mm round contact system |
| # of Power Terminals | 2 |
| Shielding | Individual |
| HVIL | Shunt on female |
| Assembly Assurance | SPA |
| Number of Indexes | 1 |



APPLICATIONS

AC / DC inverter, DC / DC converter, HV battery,
Power electric box, HV PDU

See back page for representative part numbers and packaging dimensions.

BENEFITS

- Cost effective solution with unshielded terminal holder within device replacing traditional shielded headers
- Unique and safe mating screwing with innovative Screw Position Assurance (SPA)
- Header is sealed in both mated and unmated position

FEATURES

- Robust bolt driven mate assist
- Fingersafe via plastic tips on male pins
- Cable range: ~ 50 mm² and smaller



TECHNICAL CHARACTERISTICS

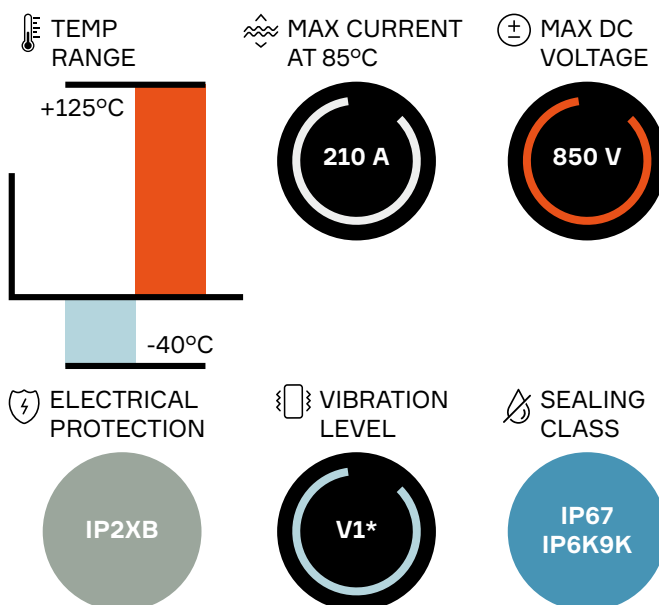

* For classification V2 please consult an Aptiv representative.

About Aptiv

Aptiv is a global technology company that develops safer, greener and more connected solutions enabling the future of mobility.

Visit aptiv.com →



• **APTIV** •

| Header* | Header with HVIL** | Mating connector | BOM |
|----------|--------------------|------------------|-----|
| 35099885 | 35099880 | 35098453 | 1 |

* Header connector is a fully assembled part and therefore has no associated parts.

** Please contact your local Aptiv representative for serial production information.

ASSOCIATED PARTS

| Part number | Description | BOM |
|-------------------------|---|-----|
| Mating connector | | |
| 13893887 | RCS 800 female terminal silver-plated 35 - 50 mm ² | 2 |
| 35082410 | Inner ferrule 35 and 50 mm ² | 2 |
| 35082415 | Outer ferrule 35 and 50 mm ² | 2 |
| 35099247 | Single wire seal & retainer 35 mm ² | 2 |
| 35099248*** | Single wire seal & retainer 50 mm ² | |
| 35092416 | RCS800 tube 35 - 50 mm ² | 2 |

*** Available only by prototype, please contact your local Aptiv representative for more information on serial production.

DIMENSION MEASUREMENT SAMPLE

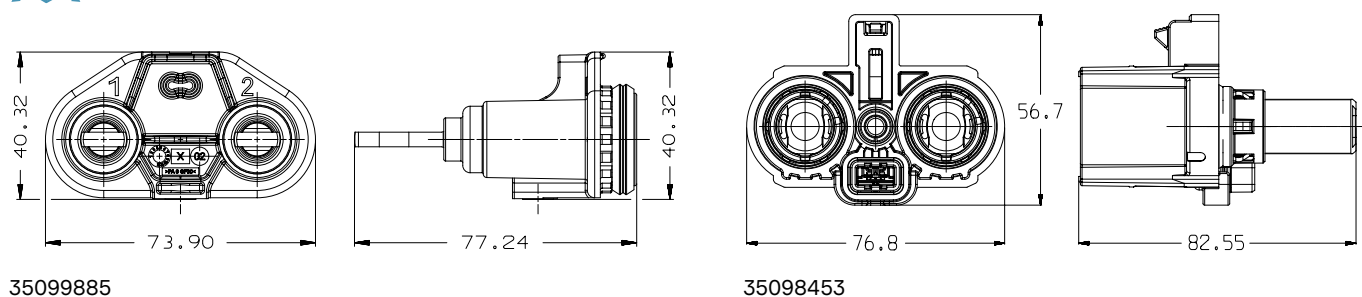

Part numbers, specifications, dimensions and performance data in this document are for general references only and are subject to change without notice. To verify product information, please contact an Aptiv representative.