

CUT OFF (SYMMETRIC)
 Befestigungsausschnitt (symmetrisch)

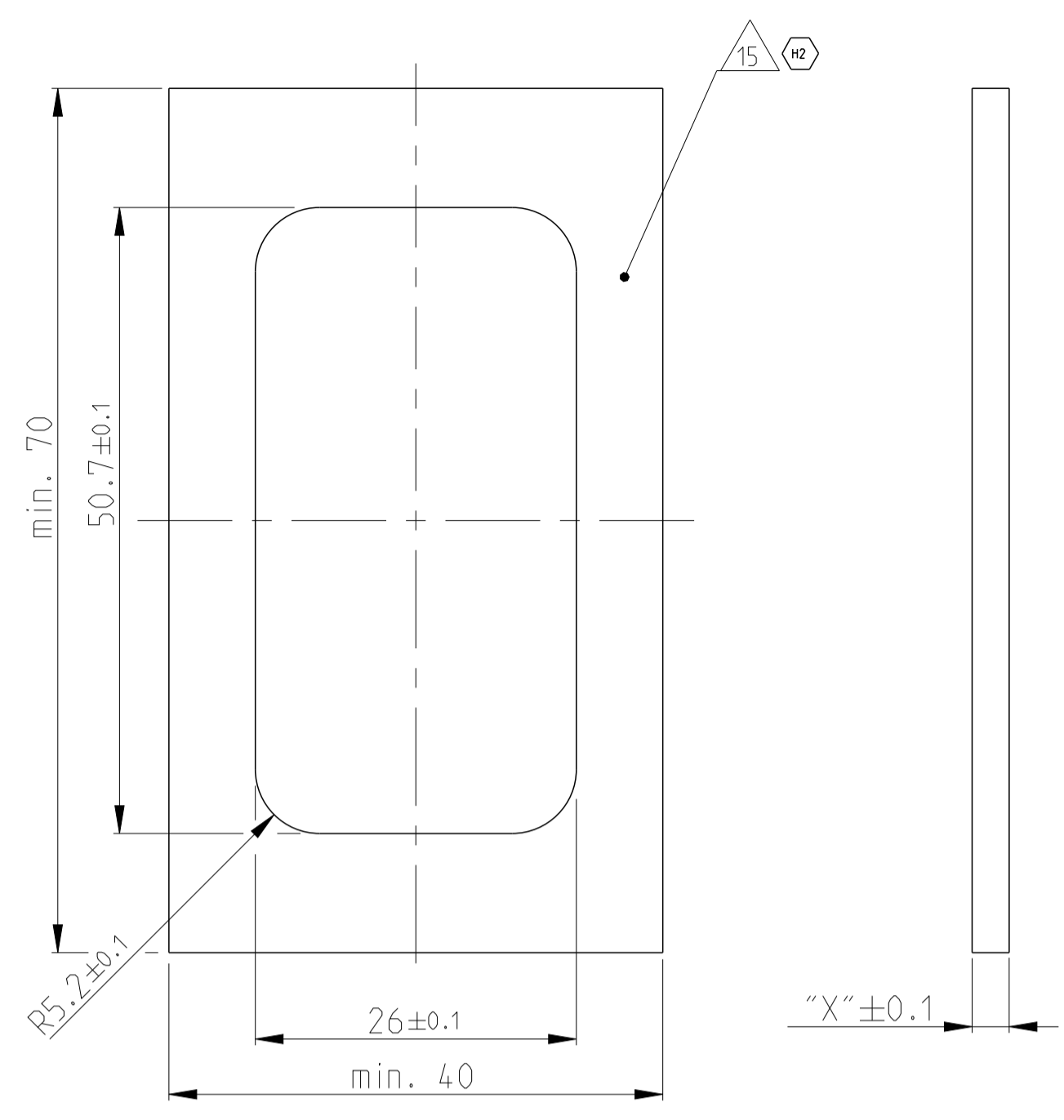

CUT OFF WITH POLARISATION
 Befestigungsausschnitt mit Polarisation

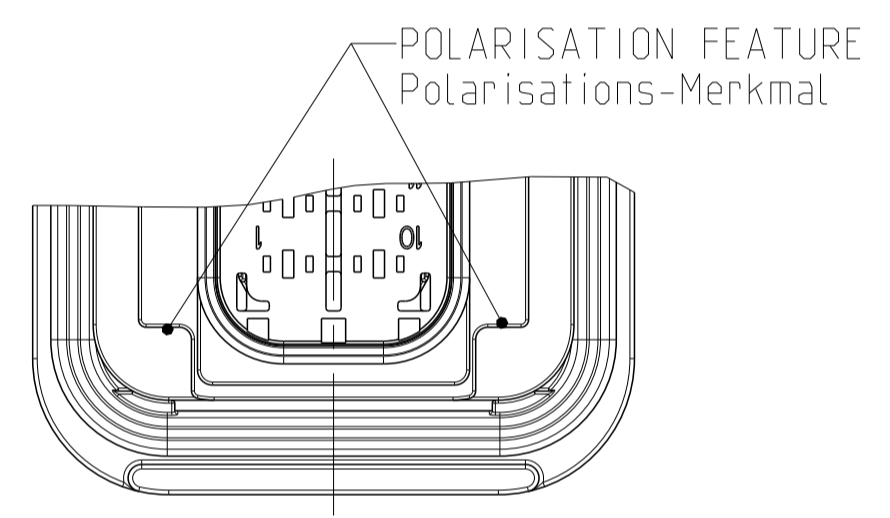
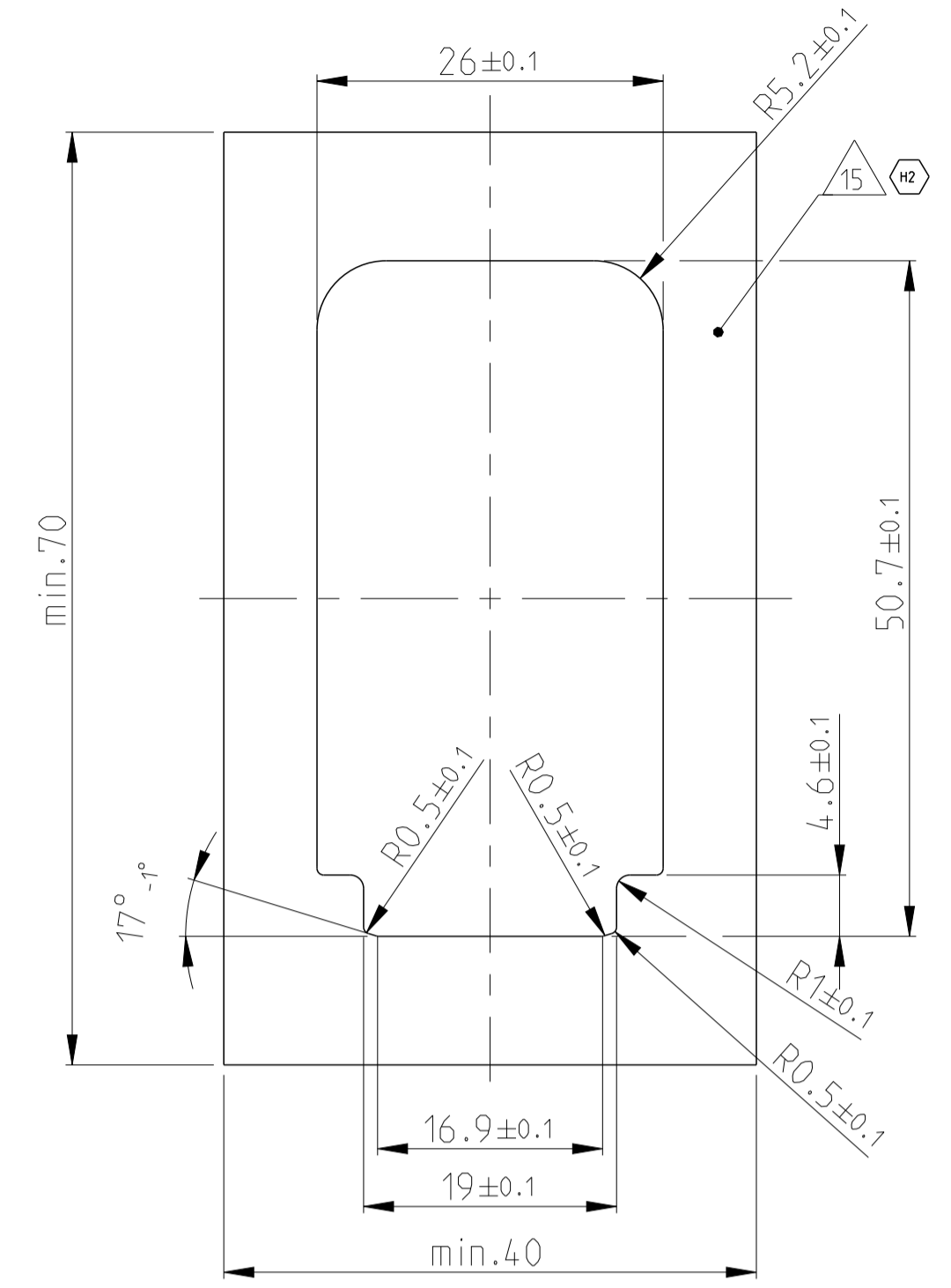

FIXING WITH SLIDE Befestigung mit Schieber	
WALLTHICKNESS "X" Wandstaerke "X"	TE ORDER NO. TE Best. Nr.
1.0mm	N.N.
1.5mm	0-1564411-5
2.5mm	0-1564411-2
3.0mm	0-1564411-1
3.5mm	0-1564411-6
4.0mm	N.N.

SLIDE FROM BOTH DIRECTIONS MOUNTABLE
 Schieber von beiden Seiten montierbar

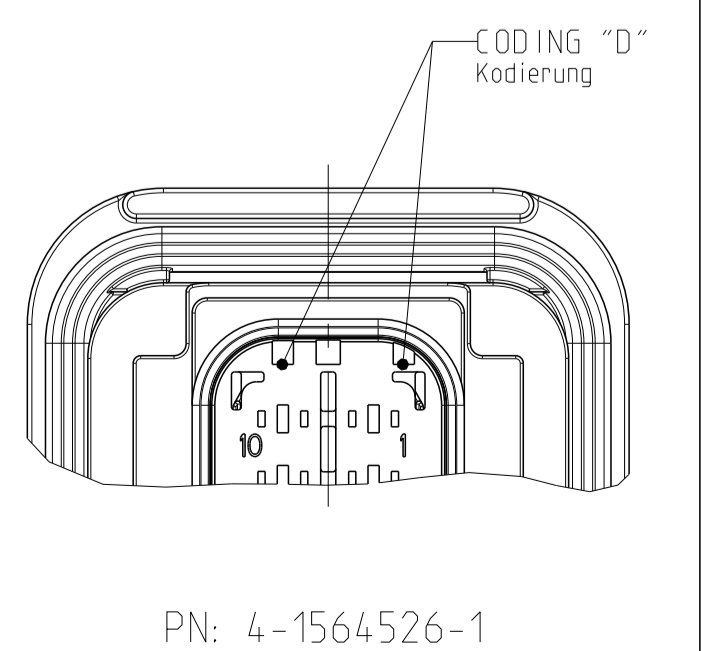
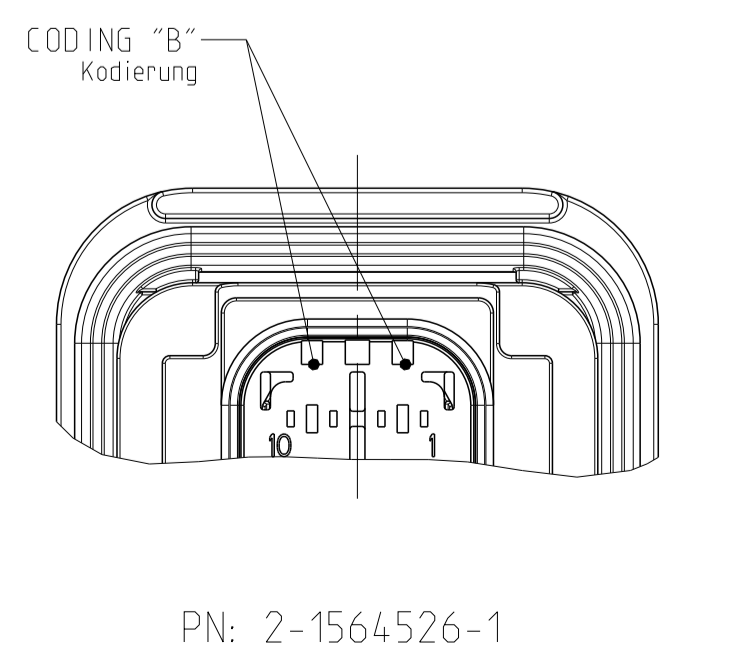
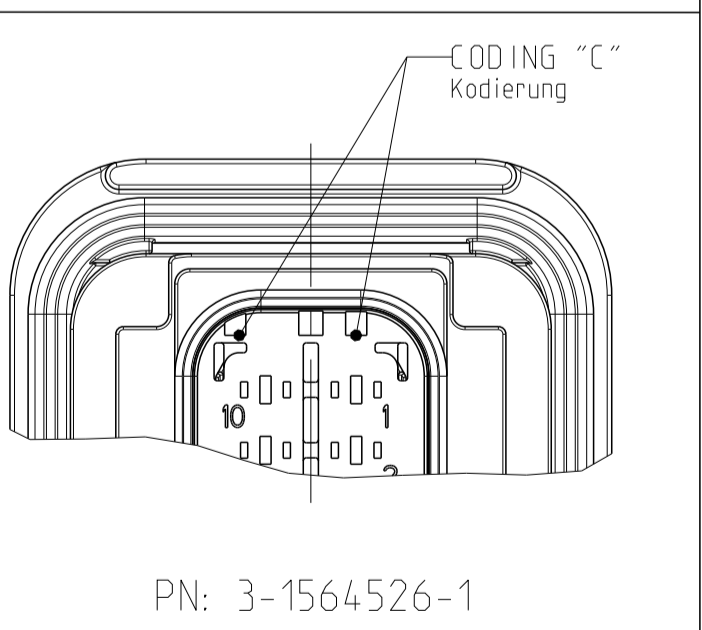
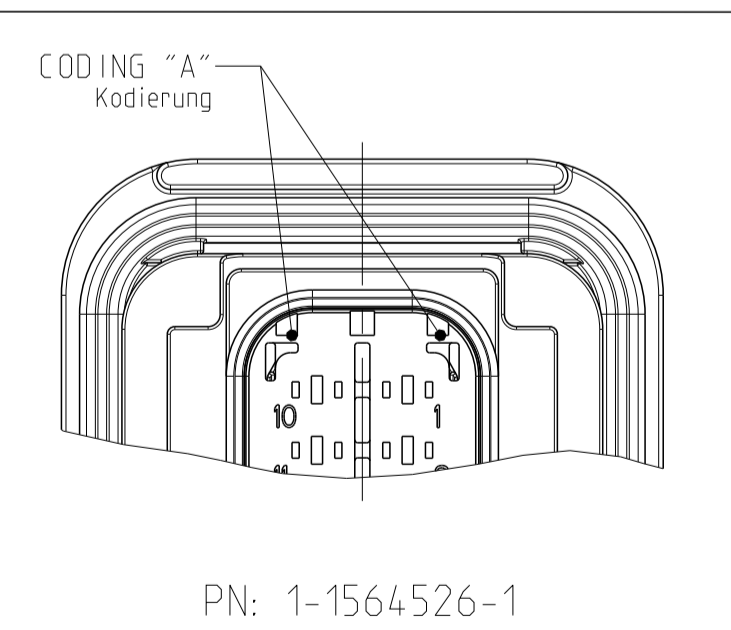
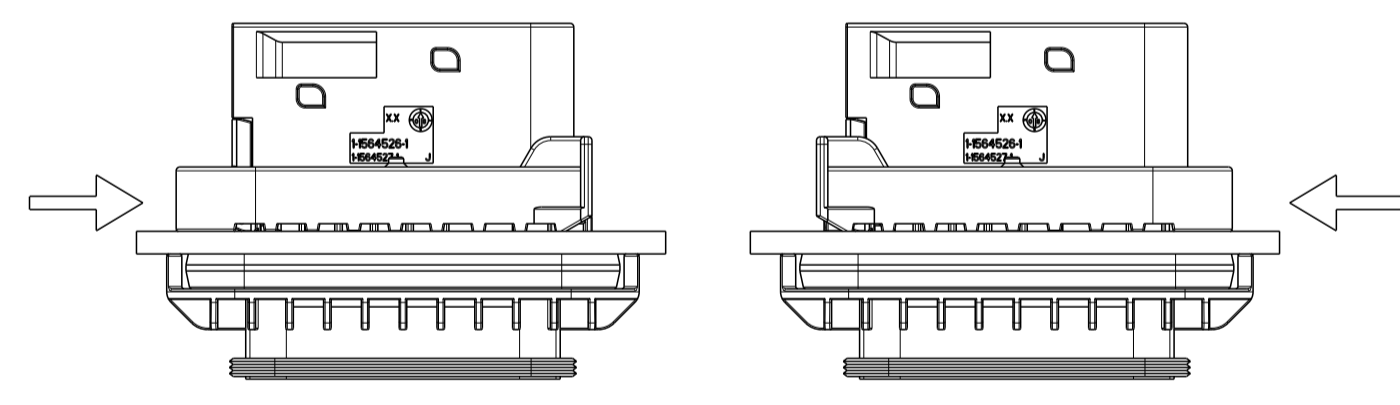

NOTES
 Bemerkungen

- TE ORDER-NO.
TE Bestell-Nr.
- CAVITY NUMBERING
Kammerbezeichnung
- PRODUCTION DATE
Produktionsdatum
- LETTER-INSERT FOR THE REVISION STATUS OF THE MOULD
Schriftsatz fuer Aenderungszustand des Werkzeugs
- MATERIAL MARKING ACCORDING TO VDA 260
Werkstoffkennzeichnung nach VDA 260
- BULK PACKAGING IN CORRUGATED BOX
Schuetztgut im Versandkarton
- MOULD CAVITY MARKING
Nestmarkierung
- TE LOGO
TE Logo
- SUITABLE COUNTERPART SEE DRAWING: 1563759
Passendes Gegenstueck siehe Zeichnung: 1563759
- CAVITIES MATED WITH TAB 1.6 x 0.6 MM (SWS)
SEE PRODUCT GROUP DRAWING
TE NO: 1355055
MAX. WIRE SIZE: 1.0mm² FLR
Kontaktkammer passend fuer Flachstecker 1.6 x 0.6 mm (EDS)
siehe Produktgruppenzeichnung
TE Nr: 1355055
max. Drahtgroessenbereich: 1.0mm² FLR
- INTERFACE ACC. Drawing: 114-18799-1
Kragenanschluss nach Zeichnung: 114-18799-1
- MATED WITH COVER SEE DRAWING: 1670865, 1670866
Passend zu Kappe siehe Zeichnung: 1670865, 1670866
- SLIDING DISTANCE OF SECONDARY LOCKING
Verschiebeweg der zweiten Kontaktsicherung
- MALFUNCTION CAUSED BY LAQUER IS NOT COVERED BY TE WARRANTY
Funktionsbeeintraechtigung durch Lackieren. Liegt nicht im Einfluss und Gewaehrleistungsumfang von TE

1-1564526-1 AS SHOWN
 1-1564526-1 wie gezeigt

SECTION G-G
 Schnitt

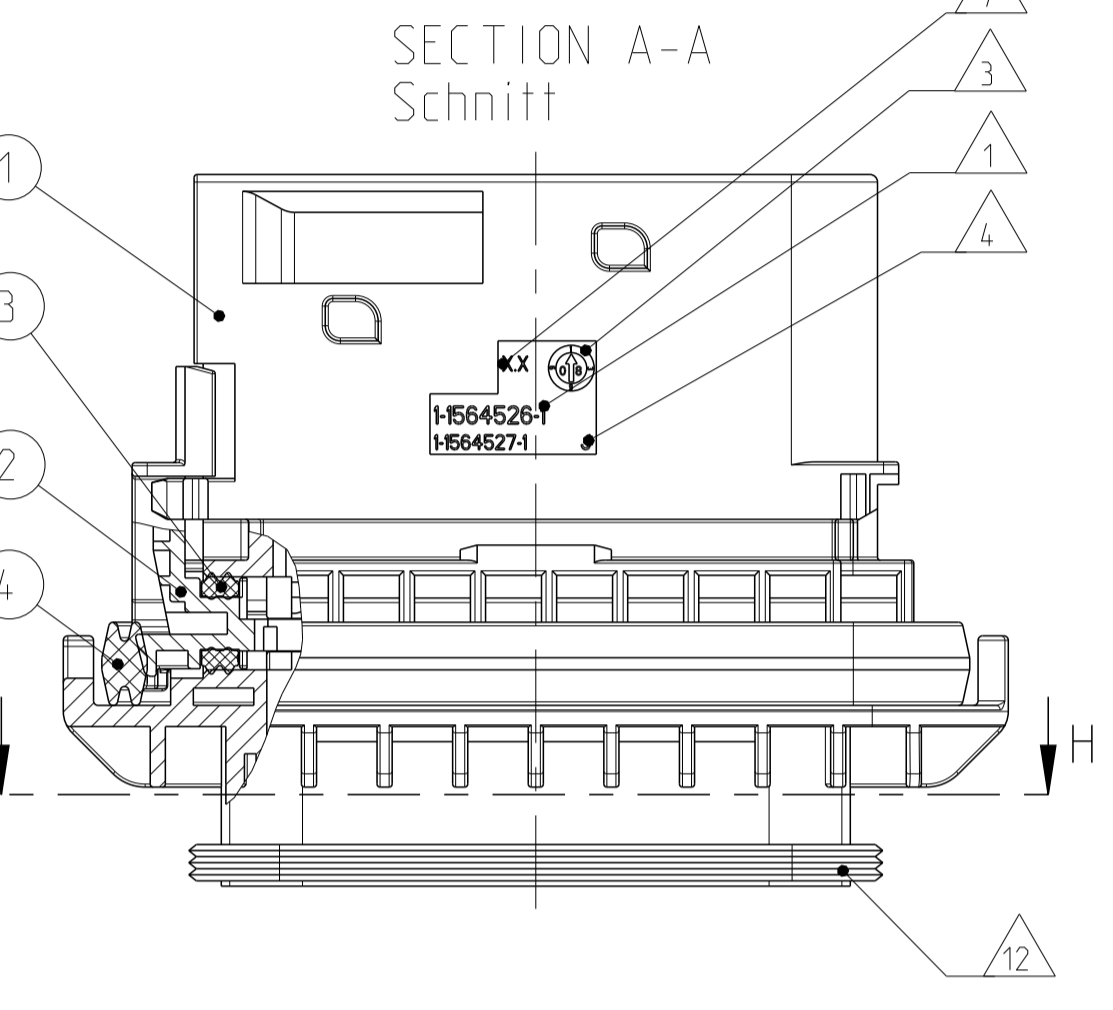
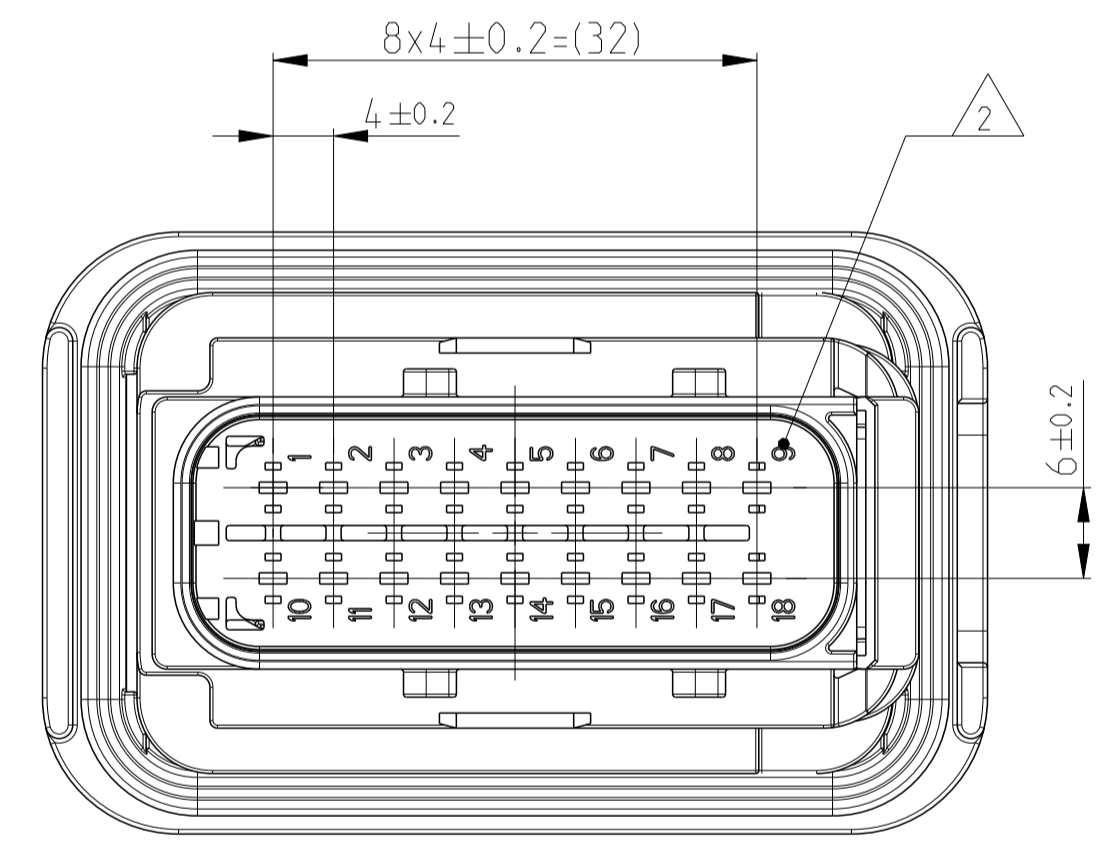
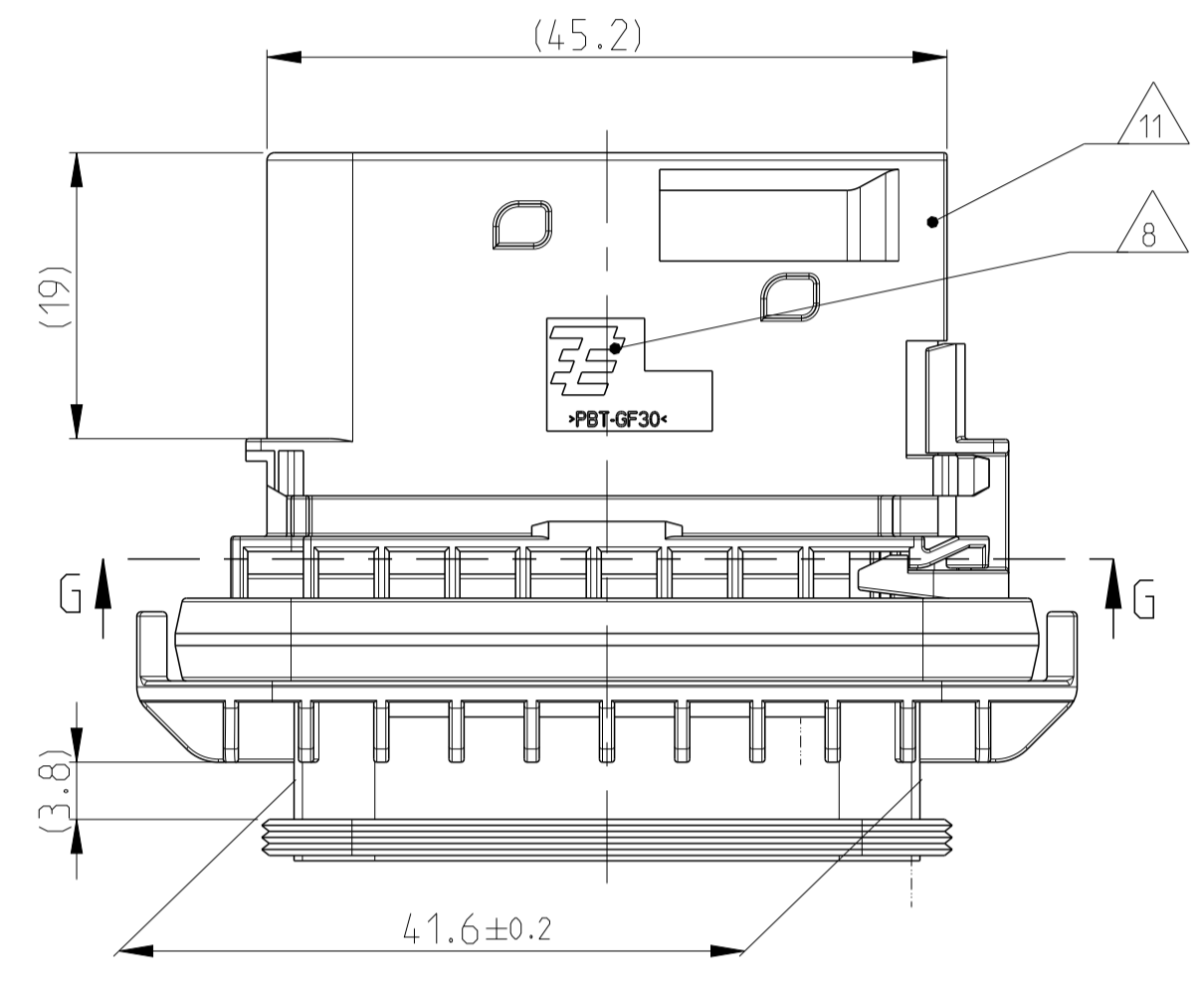
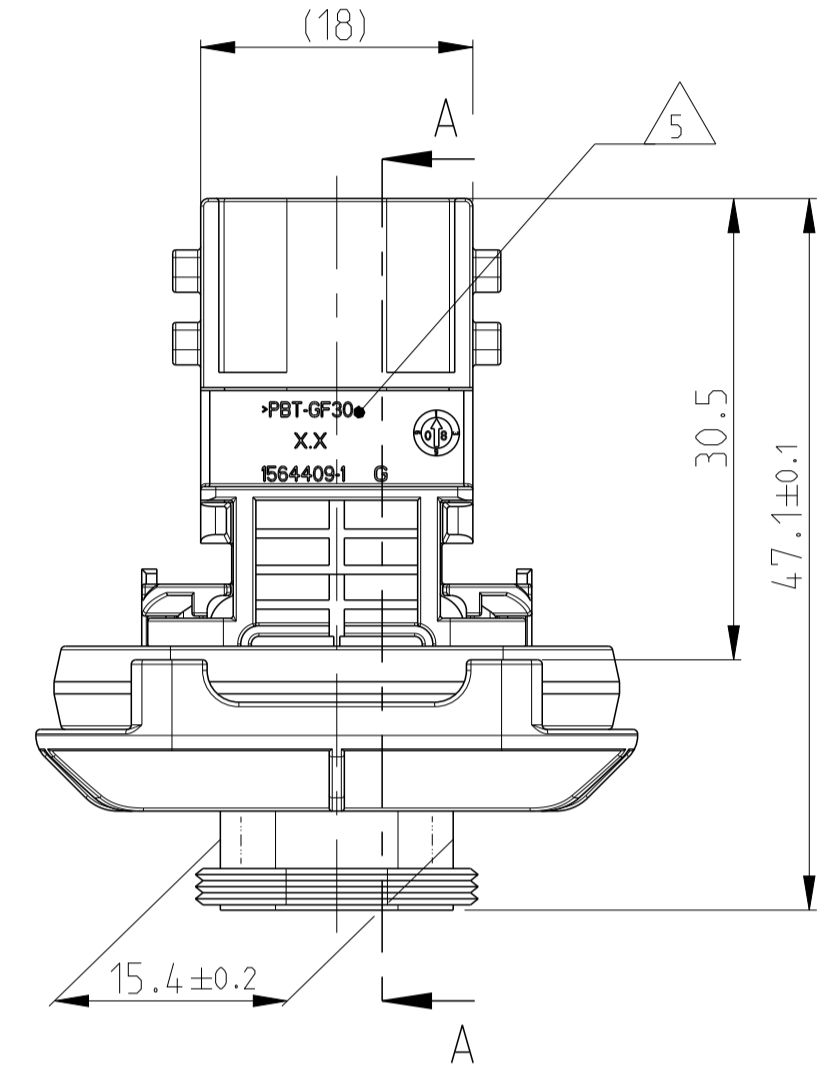
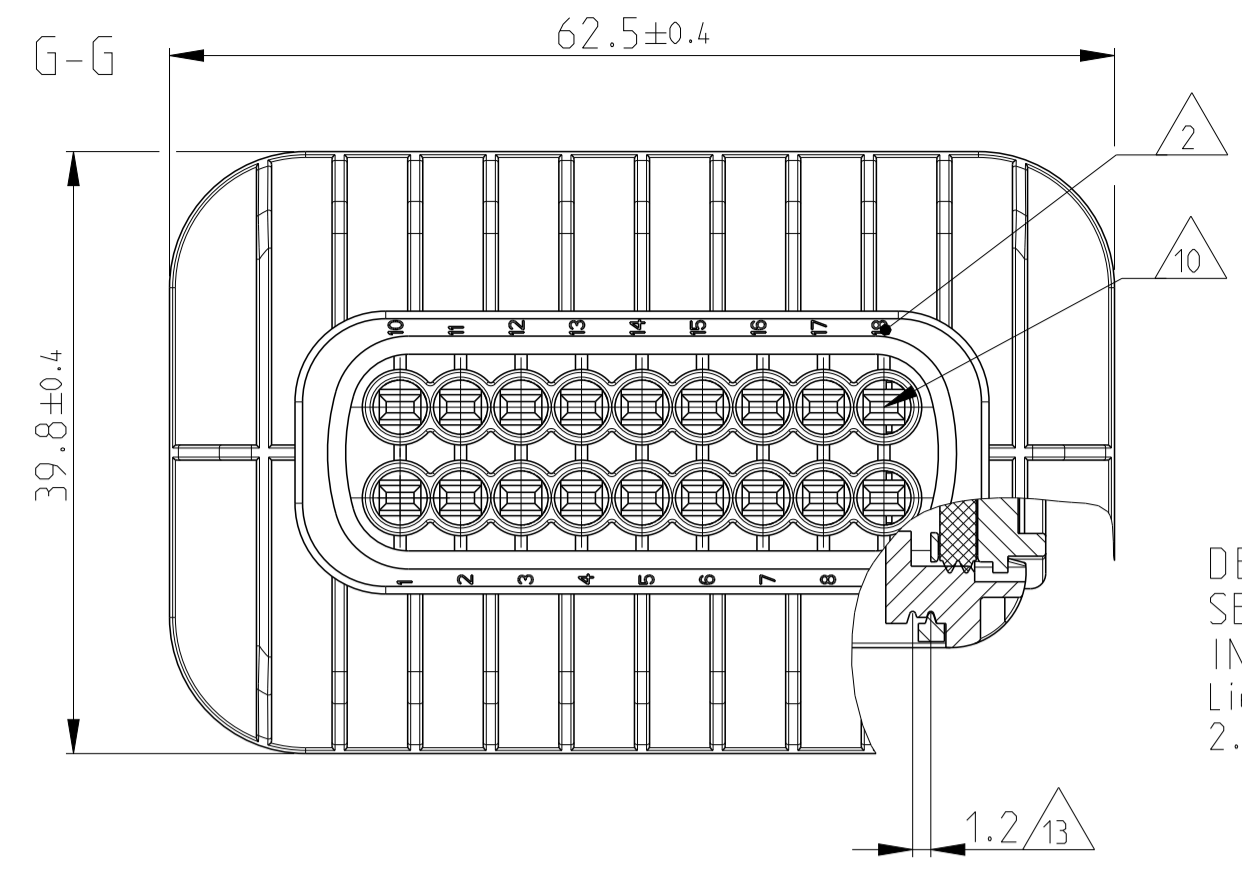

SECTION H-H
 Schnitt

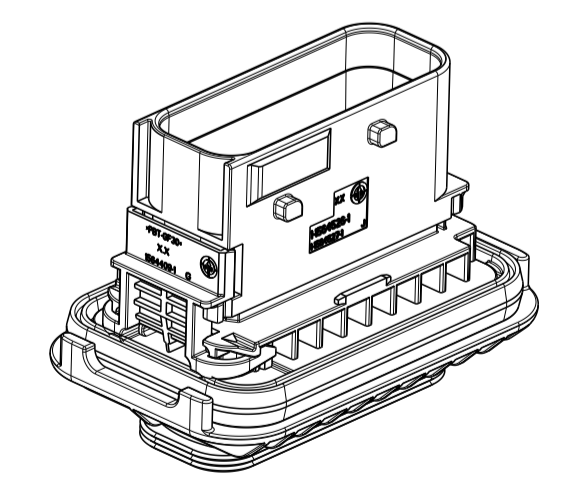
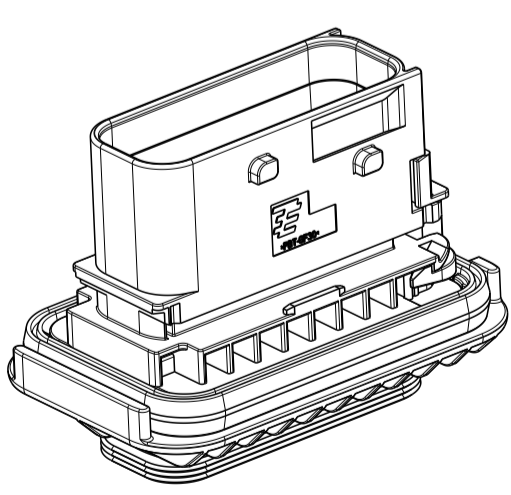
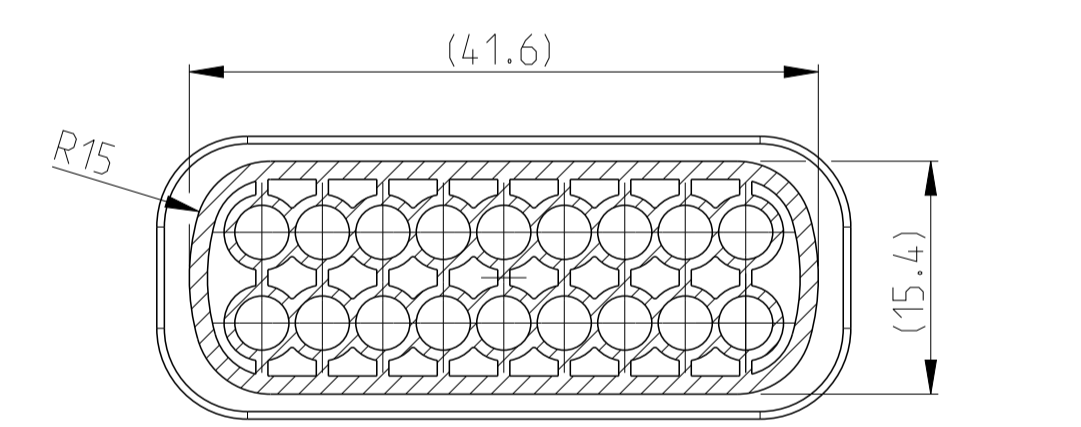

SEALING SURFACE CUTOFF
 Dichtflaeche Blechausschnitt

SURFACE ROUGHNESS Ra MAX. 1.8 µm OR LESS FOR METAL PARTS.
 Werkzeugoberflaeche Ra Max. 1.8 µm oder weniger fuer Metallteile

SURFACE ROUGHNESS MIN. VD1 3400 - CLASS 24 FOR PLASTIC PARTS.
 Werkzeugoberflaeche Min. VD1 3400 - Class 24 fuer Kunststoffteile.

THE FLATNESS MUST BE WITHIN THE TOLERANCE OF THE SHEET.
 THEREFORE WITHIN ±0.1MM.
 Die Ebenheit muss innerhalb der Toleranz des Blechs liegen bei (±0.1mm)

NO SINK MARKS, EJECTOR, DRAFT, DENTS, SCRATCHES.
 PARAGRAPH ON THE SEALING AREA ALLOWED.
 Keine Einfallstellen, Auswerfer, Ausformschraegen, Delle, Kratzer, Absaetze zulaessig.

ITEM NO	DESCRIPTION	COLOUR	MATERIAL
1	18POS. TAB HOUSING, CODE "A"	BLACK	PBT-GF30 / V-0
1	18POS. TAB HOUSING, CODE "C"	GREEN	PBT-GF30 / V-0
1	18POS. TAB HOUSING, CODE "B"	GREEN	PBT-GF30 / V-0
1	18POS. TAB HOUSING, CODE "C"	GREEN	PBT-GF30 / V-0
1	18POS. TAB HOUSING, CODE "D"	BLUE	PBT-GF30 / V-0
2	SEAL FOR SECONDARY LOCKING	YELLOW	PBT-GF30 / V-0
3	SEAL FOR SECONDARY LOCKING	WHITE	MVO
4	AXIAL SEAL 57x37	GREEN	MVO

TE ORDER-NO. TE Bestell-Nr.	REV.	NO. OF POS. Polzahl	CODE Kodierung	QUANTITY Stueck	ITEM NO NO ASSY
4-1564526-1	H	18	D	- - 1 1 1 1 1 4	4
3-1564526-1	H	18	C	- - 1 - 1 1 1 1 3	3
2-1564526-1	H	18	B	- 1 - - 1 1 1 1 2	2
1-1564526-1	H	18	A	1 - - - 1 1 1 1 1	1

THIS DRAWING IS A CONTROLLED DOCUMENT.
 DIESES ZEICHNUNGSDOKUMENT WIRD DURCH UNS KONTROLLIERT VERWALTET.
 ANSPRUCHAUF DIESE ZEICHNUNGSDOKUMENTE WIRD DURCH UNS KONTROLLIERT VERWALTET.
 THE ORIGINAL OF THIS DRAWING IS KEPT AT THE HEADQUARTERS OF THE COMPANY.

OWNER: Shilpa Bhavikatti
 DATE: 19FEB2009
 CHK: J.Grandzow
 DATE: 20FEB2009

PRODUCT SPEC: 108-94.020
 APPLICATION SPEC: 114-18756

WEIGHT: 37.11 g
 SCALE: 2:1
 SHEET: 1 OF 1
 REV: H2

Customer Drawing / KUNDENZEICHNUNG

LOC	DIST	REV	DATE	OWN	APPV
A1	-	G	19FEB2009	SB	CE
		H	22SEP2010	AK	JG
		H1	26MAY2011	CG	JG
		H2	01APR2015	Mah.	Gilch

DELIVERY CONDITION:
 SECONDARY LOCKING DEVICE
 IN PRE-LOCKED POSITION
 Lieferzustand:
 2. Kontaktsicherung in Vorrastellung